

VO Děčín

Popis : U Obory

Číslo projektu : M220920.1.A

Zákazník :

Vypracoval : Mirza Hadžiosmanovič

Datum : 22.09.2020

Následující hodnoty vycházejí z přesných výpočtů kalibrovaných světelných zdrojů, svítidel a jejich rozmístění. V praxi se mohou projevit určité odchylky. Záruční reklamace na data svítidel jsou vyloučeny.

Relux a výrobci svítidel nepřijímají žádnou odpovědnost za následné škody a škody, které vzniknou uživateli nebo třetím stranám.

1 Údaje o svítidle

1.1 Siteco, Streetlight 11 micro LED | ... (5XC1B31B08CC)

1.1.1 Specifikace svítidla

Výrobce: Siteco

5XC1B31B08CC mast luminaire Streetlight 11 micro LED | ST0.5a
5XC1B31B08CC

Streetlight 11 micro LED, mast luminaire. lighting technology 1: primary light control with 3 zone faceted reflector, of plastic, silver coated, highly specular; primary optical cover: cover, of PMMA; transparent; light distribution: ST0.5a; primary emission direction: below; primary beam angle: wide distribution; light emission: direct distribution; primary light characteristic: asymmetric; 0% light immission; excellent uniformity and glare reduction; mounting: installation type: side-entry, post-top; installation location: on mast; electrical 1: LED High Power LED; rated luminous flux: 1.630 lm; light colour: 830; colour temperature: 3000K; colour rendering: CRI > 80; control gear: ECG Plus; control: optimised constant luminous flux control (CLO 2.0), overheat protection, power reduction; digital communication interface; time-dependent luminous flux control; flexible luminous flux parameterisation; electronic power reduction; with cable H07RN-F 5x 1.5mm²; mains connection: 220..240V, AC; 50/60Hz; surge voltage resistance: 6kV 1.2/50µs; connection cable pre-assembled; cable length: 5,5 m; core identification and terminal assignment according to DIN; electronic type plate; automatic data exchange: ECG/LED module; LED unit replaceable on mast without ESD; environment; access to gear tray and ECG to be opened; tool-free; integrative ambient- and operation-dependent; constant luminous flux control (CLO 2.0); integrated ESD protection against destruction; due to static charging when mounted on non-conductive masts / suspension systems; parameterization of dimming times and light output values on the mast junction box possible; connected load: start of lifetime: 14 W; end of lifetime: 14 W; reduction: 7 W; component: luminaire housing, of diecast aluminium; powder-coated, Siteco® metallic grey (DB 702S); please order mast flange separately; inclination adjustable without tools at 0°, 5°, 10°, 15° (post-top) | 0°, -5°, -10°, -15° (side-entry); sealing non-destructively replaceable; multi-level sealing system; luminaire family consists of several construction sizes; constructive weather protection through drip edge; air-permeable membrane for pressure; equalisation prevents condensation within inner of luminaire; luminaire smart city ready; control gear can be replaced without tools; solid metal housing for good heat sinkage; flat surface for photocell mounting; luminaire design without cooling ribs; luminaire opened without tools; mast flange can be mounted on the luminaire; side without tools; screwless luminaire design; LED module can be replaced without tools, plug connection to control gear; length: 600 mm, width: 174 mm, height: 116mm; spigot size: 60/76mm (post-top) and 42/60mm (side-entry), mast flange for spigot size: 42mm: 5XC10008XM4, 60mm: 5XC10008XM2, 76mm: 5XC10008XM1; mounting height: 4..8m; weight: 5,2 kg; lighting management: Simple user guidance with automatic documentation of settings; Parameterisation of all SITECO outdoor luminaires with the LumIdent® app and Siteco® Service Box on the mast door or on the luminaire - independent of the installed ECG brand; Simple and quick identification of the luminaire by means of QR code; With only one system, call up the technical data, make parameter settings, show diagnostic data and create a luminaire register; testings/approvals/admissions: protection rating (complete): IP66; insulation class (complete): insulation class II (safety insulation); certification: CE, ENEC, VDE; impact resistance: IK09; permissible ambient temperature for outdoor applications: -25..+50°C; standard-compliant lighting for roads and squares; service life: rated service life: 100.000h (L98/B10) at AT= 25°C; packaging unit: 1 piece; manufacture: Siteco; Streetlight 11 micro LED; type: 5XC1B31B08CC.

Light Distribution: ST0.5a

Objekt : VO Děčín
Popis : U Obory
Číslo projektu : M220920.1.A
Datum : 22.09.2020

1 Údaje o svítidle

1.1 Siteco, Streetlight 11 micro LED | ... (5XC1B31B08CC)

1.1.1 Specifikace svítidla

Test report number: 58064

Údaje o svítidle

Absolutní fotometrie

Účinnost svítidel : 116.43 lm/W
Klasifikace : A30 □ 100.0% ↑ 0.0%
CIE Flux Codes : 46 73 96 100 100
Oslnění : G*3 / D6
Výkon : 14 W
Světelný tok : 1630 lm

Osazeno

Počet : 1
Označení : LED 3000K |
CRI >= 80
Barva : 3000 K
Podání barev : 80

Rozměry : 600 mm x 174 mm x 116 mm

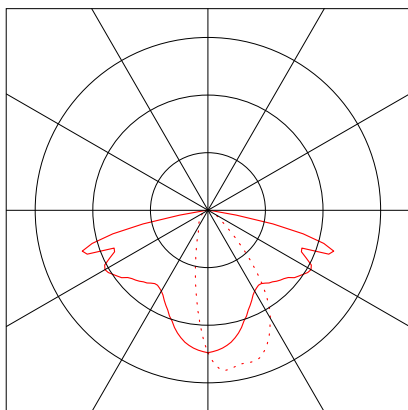

1 Údaje o svítidle

1.2 Siteco, Streetlight 11 micro LED | ... (5XC1B31B08DC)

1.2.1 Specifikace svítidla

Výrobce: Siteco

5XC1B31B08DC mast luminaire Streetlight 11 micro LED | ST0.5a
5XC1B31B08DC

Streetlight 11 micro LED, mast luminaire. * lighting technology 1: primary light control with 3 zone faceted reflector, of plastic, silver coated, highly specular; primary optical cover: cover, of PMMA; transparent; light distribution: ST0.5a; primary emission direction: below; primary beam angle: wide distribution; light emission: direct distribution; primary light characteristic: asymmetric; 0% light immission; excellent uniformity and glare reduction; * mounting: installation type: side-entry, post-top; installation location: on mast; * electrical 1: LED High Power LED; rated luminous flux: 2.820 lm; light colour: 830; colour temperature: 3000K; colour rendering: CRI > 80; control gear: ECG Plus; control: optimised constant luminous flux control (CLO 2.0), overheat protection, power reduction; digital communication interface; time-dependent luminous flux control; flexible luminous flux parameterisation; electronic power reduction; with cable H07RN-F 5x 1.5mm²; mains connection: 220..240V, AC; 50/60Hz; surge voltage resistance: 6kV 1.2/50µs; connection cable pre-assembled; cable length: 6,5 m; core identification and terminal assignment according to DIN; electronic type plate; automatic data exchange: ECG/LED module; LED unit replaceable on mast without ESD; environment; access to gear tray and ECG to be opened; tool-free; integrative ambient- and operation-dependent; constant luminous flux control (CLO 2.0); integrated ESD protection against destruction; due to static charging when mounted on non-conductive masts / suspension systems; parameterization of dimming times and light output values on the mast junction box possible; * connected load: start of lifetime: 25 W; end of lifetime: 27 W; reduction: 12 W; * component: luminaire housing, of diecast aluminium; powder-coated, Siteco® metallic grey (DB 702S); please order mast flange separately; inclination adjustable without tools at 0°, 5°, 10°, 15° (post-top) | 0°, -5°, -10°, -15° (side-entry); sealing non-destructively replaceable; multi-level sealing system; luminaire family consists of several construction sizes; constructive weather protection through drip edge; air-permeable membrane for pressure; equalisation prevents condensation within inner of luminaire; luminaire smart city ready; control gear can be replaced without tools; solid metal housing for good heat sinkage; flat surface for photocell mounting; luminaire design without cooling ribs; luminaire opened without tools; mast flange can be mounted on the luminaire; side without tools; screwless luminaire design; LED module can be replaced without tools, plug connection to control gear; length: 600 mm, width: 174 mm, height: 116mm; spigot size: 60/76mm (post-top) and 42/60mm (side-entry), mast flange for spigot size: 42mm: 5XC10008XM4, 60mm: 5XC10008XM2, 76mm: 5XC10008XM1; mounting height: 4..8m; weight: 5,2 kg; lighting management: Simple user guidance with automatic documentation of settings; Parameterisation of all SITECO outdoor luminaires with the LumIdent® app and Siteco® Service Box on the mast door or on the luminaire - independent of the installed ECG brand; Simple and quick identification of the luminaire by means of QR code; With only one system, call up the technical data, make parameter settings, show diagnostic data and create a luminaire register; * testings/approvals/admissions: protection rating (complete): IP66; insulation class (complete): insulation class II (safety insulation); certification: CE, ENEC, VDE; impact resistance: IK09; permissible ambient temperature for outdoor applications: -25..+50°C; standard-compliant lighting for roads and squares; * service life: rated service life: 100.000h (L97/B10) at AT= 25°C; packaging unit: 1 piece; * manufacture: Siteco; Streetlight 11 micro LED; * type: 5XC1B31B08DC.

Light Distribution: ST0.5a

Objekt : VO Děčín
Popis : U Obory
Číslo projektu : M220920.1.A
Datum : 22.09.2020

1 Údaje o svítidle

1.2 Siteco, Streetlight 11 micro LED | ... (5XC1B31B08DC)

1.2.1 Specifikace svítidla

Test report number: 58064

Údaje o svítidle

Absolutní fotometrie

Účinnost svítidel : 111.02 lm/W
Klasifikace : A30 □ 100.0% ↑ 0.0%
CIE Flux Codes : 46 73 96 100 100
Oslnění : G*3 / D5
Výkon : 25.4 W
Světelný tok : 2820 lm

Osazeno

Počet : 1
Označení : LED 3000K |
CRI >= 80
Barva : 3000 K
Podání barev : 80

Rozměry : 600 mm x 174 mm x 116 mm

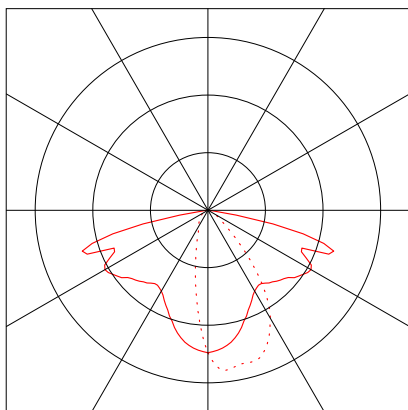

2 Venkovní osvětlení 1

2.1 Popis, Venkovní osvětlení 1

2.1.1 Půdorys

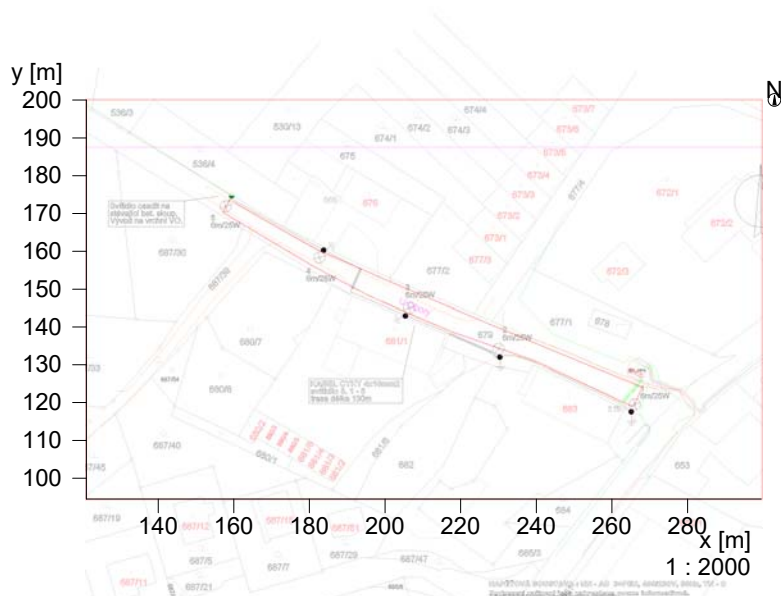

2 Venkovní osvětlení 1

2.2 Přehled výsledků, Venkovní osvětlení 1

2.2.1 Přehled výsledků, Měřicí rovina 1

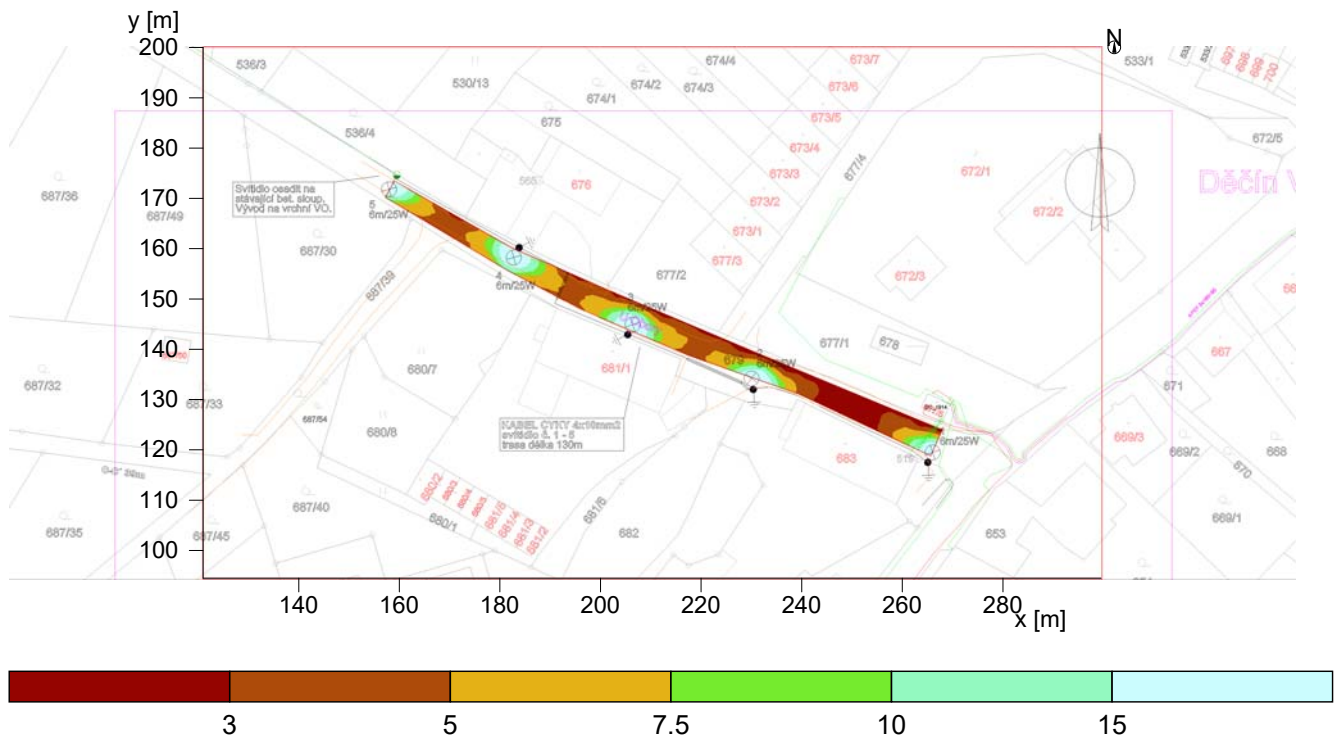

Obecně

Použitý algoritmus výpočtu

Výška hodnotící plochy

Výška (fot. střed) [m]:

Udržovací činitel

Složka přímá

0.00 m

6.00 m

0.90

Celkový světelný tok všech zdrojů

(Množství světelného toku se liší od fotometrických údajů.)

11280 lm (dimmed to 80.00%)

Celkový výkon

Celkový výkon na ploše (18831.75 m²)

127 W

0.01 W/m²

Intenzity osvětlení

Udržovaná osvětlenost

Minimální osvětlenost

Maximální osvětlenost

Rovnoměrnost U_o

Rovnoměrnost U_d

Em

E_{min}

E_{max}

E_{min}/E_{em}

E_{min}/E_{max}

6.7 lx

1.4 lx

30.5 lx

1:4.85 (0.21)

1:22 (0.05)

Typ Č. výrobce

2 5

Siteco

Objednací č. : 5XC1B31B08DC

Název svítidla : Streetlight 11 micro LED | ST0.5a

Osazení : 1 x LED 3000K | CRI >= 80 25.4 W / 2820 lm